

VILLAGE OF ROCKBRIDGE CO. ILL. 1910

OLD LIMITS  
NEW LIMITS  
Feb-1895  
ORD. 95-1

COUNTY ROAD 7/10 MILES  
1/100 NORTH

WAGON  
IN 35' FROM CENTER OF  
ROAD

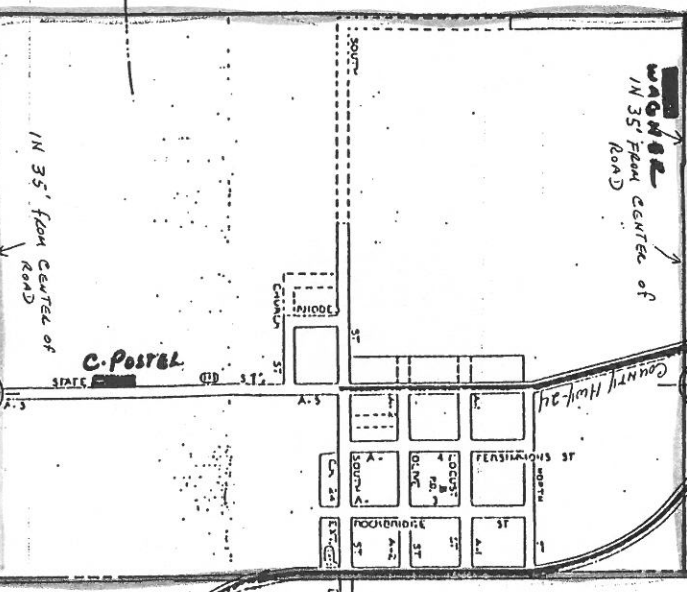

IN 35' FROM CENTER OF  
ROAD

C. POSTAL

T. 9101

101325  
STATE OF ILLINOIS }  
COUNTY OF GREENE }  
This instrument was filed for record on  
this 21st day of February 1910.  
Recorded in Book 21 Page 325  
Pub. S. 2190  
Recorder

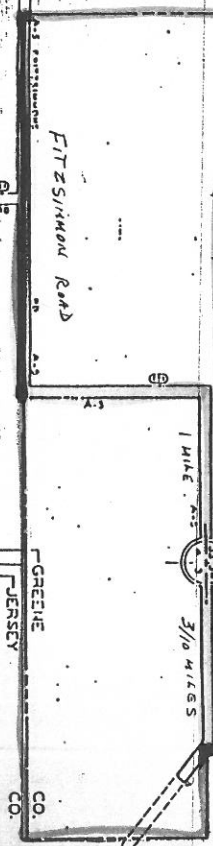

FITZSIMMONS ROAD

1 MILE  
3/10 MILES

GREENIE CO.  
JERSEY CO.

GENERAL HIGHWAY MAP  
VILLAGE OF  
ROCKBRIDGE, ILL.